

SOLID STATE DEVICES, INC.

14005 Stage Road * Santa Fe Springs, Ca 90670
 Phone: (562) 404-4474 * Fax: (562) 404-1773

Designer's Data Sheet

- FEATURES:**
- Average Output Current 0.5Amps
 - 2500 to 25000 V Blocking Voltage
 - Ultrafast Recovery: 180 nsec Maximum
 - Low Reverse Leakage Current
 - Corona Free Construction
 - Glass Passivated Rectifiers
 - Hermetically Sealed Discretes
 - Superior Thermal Shock Resistance
 - TX and TXV Level Screening Available

**SDA2500F
 thru
 SDA25000F**

**0.5 AMPS
 2.5kV thru 25kV
 FAST RECOVERY
 RECTIFIER ASSEMBLY**

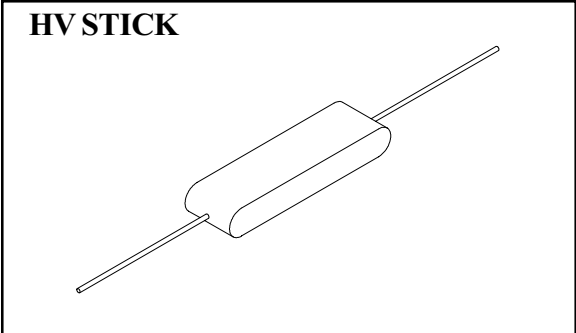

Maximum Ratings	SYMBOL	VALUE	UNITS
Peak Repetitive Reverse and DC Blocking Voltage	SDA2500F SDA5000F SDA7500F SDA10000F SDA12500F SDA15000F SDA20000F SDA25000F	2500 5000 7500 10000 12500 15000 20000 25000	Volts
Average Rectified Forward Current (Resistive load, 60Hz, Sine Wave, T _A = 25°C, No Heatsink)	I _o	0.5	Amps
Peak Surge Current (8.3 ms Pulse, Half Sine Wave, T _A = 25°C, per leg)	I _{FSM}	25	Amps
Operating and Storage Temperature	T _{OP} & T _{stg}	-55 TO +150	°C

NOTE: All specifications are subject to change without notification. SCD's for these devices should be reviewed by SSDI prior to release.

DATA SHEET # : RA0007A DataSheet4U.com

SDA2500F thru SDA25000F

PRELIMINARY

SOLID STATE DEVICES, INC.

 14005 Stage Road * Santa Fe Springs, Ca 90670
 Phone: (562) 404-4474 * Fax: (562) 404-1773

ELECTRICAL CHARACTERISTIC ^{1/}		SYMBOL	MAXIMUM	UNITS
Instantaneous Forward Voltage Drop ($I_F = 0.5A$, 300 - 500 μ sec pulse)	SDA2500F	V_{F1}	4.5	Vdc
	SDA5000F		7.5	
	SDA7500F		12.0	
	SDA10000F		15.0	
	SDA12500F		19.5	
	SDA15000F		22.5	
	SDA20000F		30.0	
	SDA25000F		37.5	
Reverse Leakage Current (Rated V_R , 300 μ s pulse minimum)		I_{R1}	2	μ A
Reverse Leakage Current (Rated V_R , $T_A = 100^\circ C$, 300 μ s pulse minimum)		I_{R2}	0.25	mA
Reverse Recovery Time ($I_F = 0.5A$, $I_R = 1.0A$, $I_{RR} = 0.25A$)		t_{RR}	180	nsec

^{1/} $T_A = 25^\circ C$, Unless otherwise specified

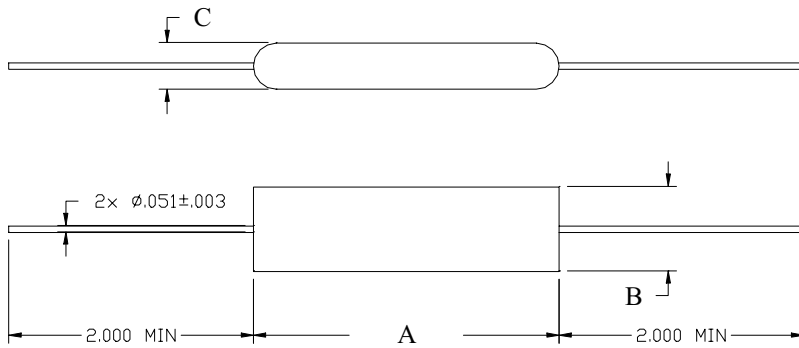
CASE OUTLINE: HV STICK

PART NUMBER	A $\pm .030$	B $\pm .020$	C $\pm .010$
SDA2500F	1.125	0.500	0.250
SDA5000F	1.125	0.500	0.250
SDA7500F	1.625	0.500	0.250
SDA10000F	2.000	0.500	0.250
SDA12500F	2.375	0.500	0.250
SDA15000F	2.750	0.500	0.250
SDA20000F	3.500	0.500	0.250
SDA25000F	4.250	0.500	0.250